

# CWDM Coarse Wavelength Division Multiplexer

## PRODUCT DESCRIPTION

CWDM series DWDM's type channel space is 20nm , with the feature of wide channel, low insertion loss, high isolation, high reliability, high stability, No epoxy glue in optical line and Compact structure. The standard type has 8 channels, mainly used in metropolitan network and access network for multiplexing/de-multiplexing.

## PRODUCT FEATURE

- ▶ Low insertion loss.
- ▶ High channel isolation.
- ▶ Low Polarization Dependent Loss.
- ▶ Exceptional reliability and stability.

## MAIN APPLICATION

- ▶ Access Networks.
- ▶ Metro WDM Systems.
- ▶ Enterprise Networks.

## SPECTRAL PLOT

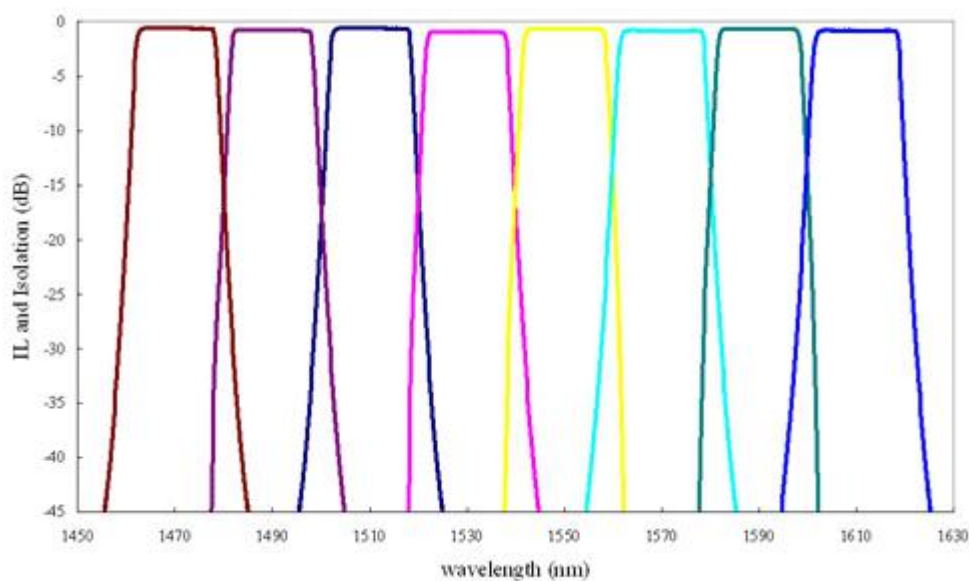

## DIMENSIONS DRAWING

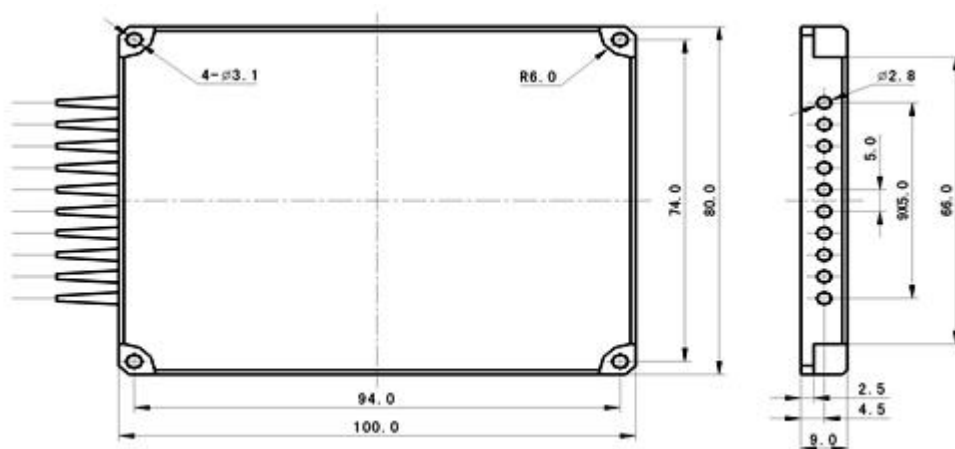

## TECHNIQUE INDEX

Performance		CWDM-□□ A	CWDM-□□ B
Operating wavelength	(nm)	1270, 1290, 1310, 1330, 1350, 1370, 1390, 1410, 1430, 1450, 1470, 1490, 1510, 1530, 1550, 1570, 1590, 1610	
Center wavelength accuracy	(nm)	±0.5	
Channel spacing	(nm)	20	
Channel passband (@-0.5dB bandwidth)	(nm)	≥13	
Insertion loss over passband (Excluding connectors)	(dB)	≤3.8	≤6.0
Channel uniformity	(dB)	≤1.0	≤1.5
Isolation	Adjacent	≥30	
	Non-adjacent	≥40	
Polarization dependent loss		≤0.10	
Polarization mode dispersion	(ps)	≤0.1	
Directivity	(dB)	≥50	
Return loss	(dB)	≥45	
Power handling	(mW)	300	
Operating temperature	(°C)	0~+70	
Storage temperature	(°C)	-40~+85	
Fiber type		9/125/900μ fiber	
Fiber length	(m)	0.5±0.02	
Size	(")	19×10.7×1.25	

